

NEW YORK, NEW YORK

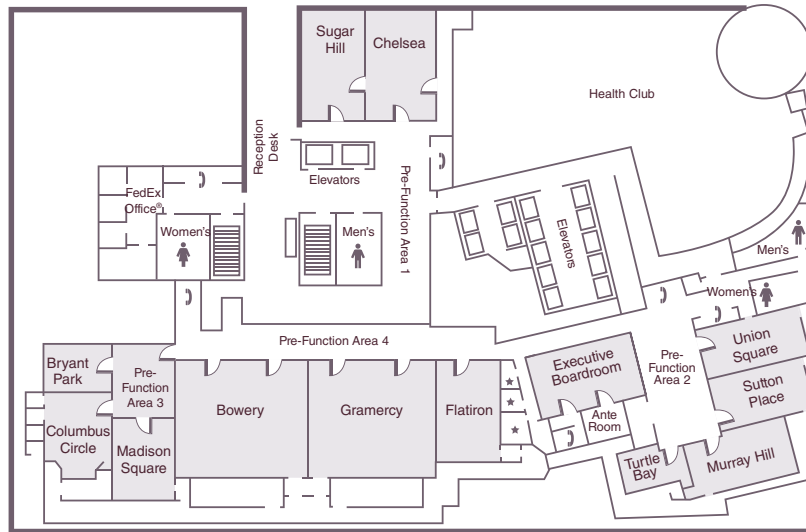

LOWER LEVEL MEETING SPACE



LOWER LEVEL MEETING ROOM DIMENSIONS AND SEATING CAPACITY

Room Name	Dimensions	Height	Square Ft.	Sq. Meters	Theater	Classroom	Conference	U-shape	Hollow Sq	Rounds of 10
BRYANT PARK	15' X 22'4"	8'6"	335	31	28	14/21	12	10	12	20
COLUMBUS CIRCLE	30'5" X 26'7"	10'	780	72	50	24/36	16	20	20	50
MADISON SQUARE	22' X 28'4"	10'	616	57	50	20/30	16	20	24	50
BOWERY	45'6" X 40'11"	12'4"	1829	169	180	60/96	36	32	40	130
GRAMERCY	46'6" X 40'10"	11'6"	1868	173	180	60/96	36	32	40	130
FLATIRON	22'1" X 34'10"	10'6"	753	70	60	28/42	20	20	24	50
TURTLE BAY	24'7" X 10'4"	9'6"	256	23	15	8/12	12	10	8	20
MURRAY HILL	38' X 19'7"	8'9"	748	67	55	30/45	20	20	24	50
SUTTON PLACE	20'1" X 32'11"	8'9"	645	60	55	26/34	20	20	24	50
UNION SQUARE	18'5" X 36'	8'9"	666	61	55	28/42	20	20	24	50
SUGAR HILL	47'2" X 24'4"	8'	1,128	104	70	30/45	28	24	28	70
CHELSEA	25'4" X 36'8"	8'	934	86	70	32/48	28	20	24	60
EXECUTIVE BOARDROOM	37'5" X 24'1"	10'6"	903	83	-	-	20	-	-	-



SECOND FLOOR

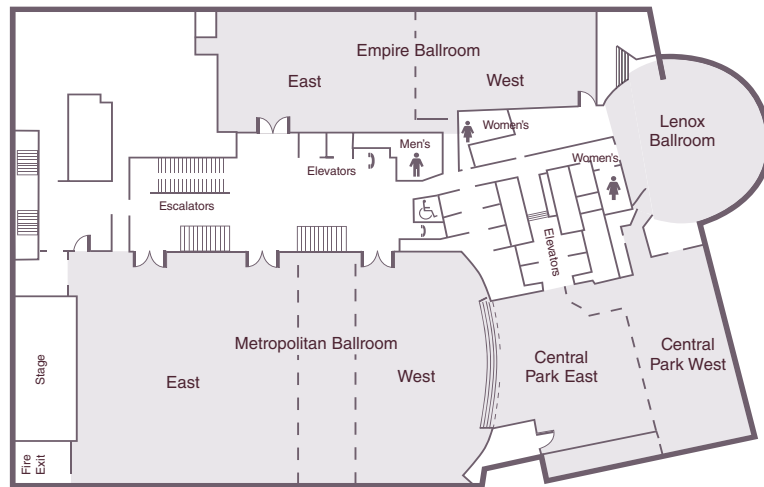

SECOND FLOOR ROOM DIMENSIONS AND SEATING CAPACITY

Room Name	Dimensions	Height	Square Ft.	Sq.Meters	Theater	Classroom	Conference	Reception	Rounds of 10	U-shape	Hollow Sq
METROPOLITAN BALLROOM	153' X 95'	21'9"	14,535	1,350	1,700	1,000	-	2,500	1,600	130	160
METROPOLITAN EAST LARGE	105' X 95'	21'9"	9,975	926	1,200	600	-	1,500	1,000	100	130
METROPOLITAN EAST SMALL	85' X 95'	21'9"	8,075	750	850	450	-	1,000	800	80	110
METROPOLITAN WEST LARGE	70' X 95'	21'9"	6,650	617	700	450	-	800	640	70	90
METROPOLITAN WEST SMALL	51' X 95'	21'9"	4,845	450	500	300	-	500	400	60	80
EMPIRE BALLROOM	147' X 47'	10'8"	6,909	641	650	350	-	800	480	110	120
EMPIRE EAST	76'3" X 48'	10'8"	3,662	340	400	200	60	300	340	60	70
EMPIRE WEST	71'5" X 38'	10'8"	2,717	252	270	150	50	250	180	40	50
CENTRAL PARK EAST	63'5" X 67'	10'7"	3,178	295	130	60	30	350	250	-	-
CENTRAL PARK WEST	33'1" X 84'	9'7"	2,780	258	250	150	50	300	180	40	50
LENOX BALLROOM	62'5" X 54'	11'10"	2,791	311	100	48	30	200	150	-	-

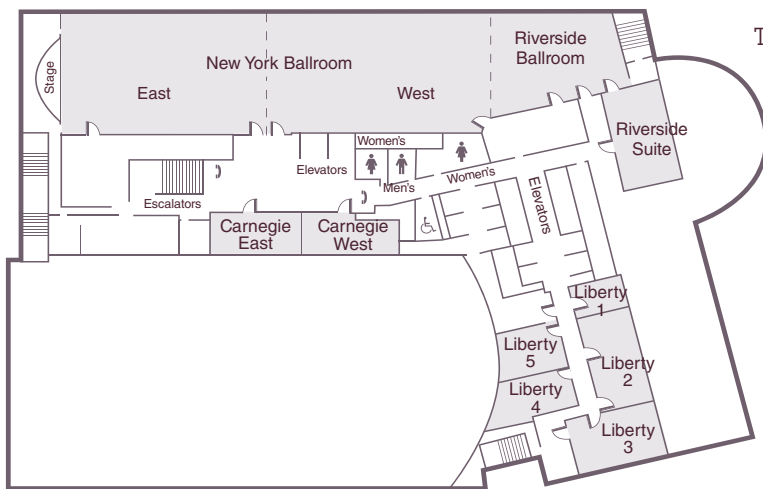

THIRD FLOOR

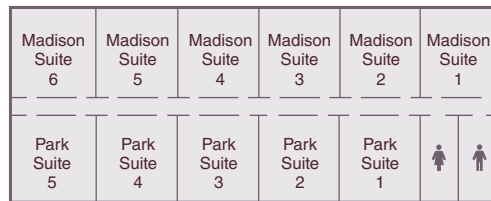

FIFTH FLOOR

THIRD AND FIFTH FLOOR ROOM DIMENSIONS AND SEATING CAPACITY

Room Name	Dimensions	Height	Square Ft.	Sq.Meters	Theater	Classroom	Conference	Reception	Rounds of 10	U-shape	Hollow Sq
NEW YORK BALLROOM	175'5" X 47'8"	11.11'	8,388	779	800	470	-	800	600	150	-
NEW YORK EAST	82'5" X 47'8"	11.11'	3,943	366	325	220	80	400	320	70	90
NEW YORK WEST	95' X 47'8"	11.11'	4,541	421	350	250	85	400	350	75	90
RIVERSIDE BALLROOM	51' X 41'	9.10'	2,091	194	125	78	40	150	120	40	50
RIVERSIDE SUITE	40' X 25'	8.9'	1,000	92	70	48	30	70	60	36	40
LIBERTY 1 & 2	20' X 41'	9.3'	820	76	40	30	30	40	40	-	-
LIBERTY 1	20'6" X 20'	9'	412	38	20	15	15	20	20	-	-
LIBERTY 2	20'6" X 21'	9'	432	40	20	15	15	20	20	-	-
LIBERTY 3	33'11" X 22'	9'	728	67	60	50	30	50	60	30	-
LIBERTY 4	17' X 36'	9.2'	612	56	50	30	25	40	30	-	-
LIBERTY 5	22' X 29'	9.2'	638	59	50	30	25	40	40	25	-
CARNEGIE EAST	35' X 15'	9'	525	48	45	30	25	40	40	-	-
CARNEGIE WEST	39' X 15'	8'11"	585	54	45	30	30	40	40	-	-
5th Floor Room	Dimensions	Height	Square Ft.	Sq.Meters	Theater	Classroom	Conference	Reception	Rounds of 10	U-shape	Hollow Sq
PARK 1, 2, 3, 4 & 5	22'11" X 22'	8'	308	43	30	21	18	25	24	-	-
MADISON 1, 2, 3, 4, 5 & 6	22'11" X 24'10"	8'	352	49	30	21	18	25	24	-	-
4TH FL. BOARDROOM	18' X 17'	8'	306	-	-	-	12	-	-	-	-